

Ball Plungers (continued)

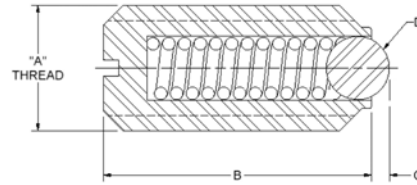

Standard End Pressure – Metric

Steel Part No.	Stainless Steel Part No.	End Force (Newtons)		A	B	C	D
		Initial	Final				
69001X	69101X	1,5	3	M3x0.5	7	0,5	1,5
63901X	64001X	4	10	M4x0.7	9	0,8	2,5
69002X	69102X	6	11	M5x0.8	12	0,9	3
63902X	64002X	9	13	M6x1.0	14	1	3,5
63905X	64005X	15	30	M8x1.25	16	1,5	5
63908X	64008X	20	35	M10x1.5	19	2	6
63911X	64011X	30	55	M12x1.75	22	2,5	8
69003X	69103X	65	125	M16x2.0	24	3,5	10
69004X	69104X	80	160	M20x2.5	30	4,5	12

Heavy End Pressure – Metric

Steel Part No.	Stainless Steel Part No.	End Force (Newtons)		A	B	C	D
		Initial	Final				
69010X	69110X	5	7	M3x0.5	7	0,5	1,5
69011X	69111X	12	22	M4x0.7	9	0,8	2,5
69012X	69112X	19	30	M5x0.8	12	0,9	3
63904X	64004X	28	40	M6x1.0	14	1	3,5
69013X	69113X	47	73	M8x1.25	16	1,5	5
69014X	69114X	66	100	M10x1.5	19	2	6
69015X	69115X	66	120	M12x1.75	22	2,5	8
69016X	69116X	90	180	M16x2.0	24	3,5	10
69017X	69117X	115	240	M20x2.5	30	4,5	12

Available without locking element only

NEW

Ball Plungers – Hexagon Socket

- Material:
 - Steel Body: ball in steel, spring steel D
- Surface finish:
 - Steel: black oxide finish
 - Stainless Steel Body: 300 series, ball 400 series, spring 300series

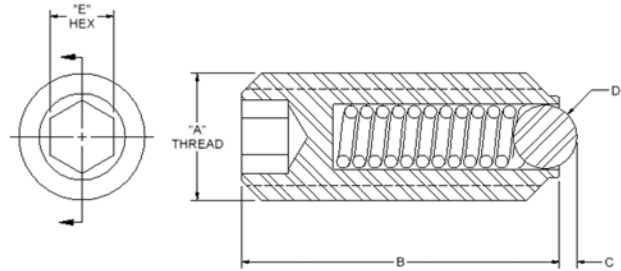

Standard End Pressure – Inch

Steel Part No.	Stainless Steel Part No.	End Force (lbs)		A	B	C	D	E
		Initial	Final					
55001X	55101X	2.0	2.9	1/4-28	15	1	3.5	1/8
55002X	55102X	2.0	2.9	1/4-20	15	1	3.5	1/8
55003X	55103X	3.4	6.7	5/16-18	18	1.5	5	5/32
55004X	55104X	4.5	7.9	3/8-16	23	2	6	3/16
55005X	55105X	6.7	12.4	1/2-13	26	2.5	8	7/32
55006X	55106X	14.6	28.1	5/8-11	33	3.5	10	5/16

Heavy End Pressure – Inch

Steel Part No.	Stainless Steel Part No.	End Force (lbs)		A	D	B	C	E
		Initial	Final					
55010X	55110X	6.3	9.0	1/4-28	15	1	3.5	1/8
55011X	55111X	6.3	9.0	1/4-20	15	1	3.5	1/8
55012X	55112X	10.6	16.4	5/16-18	18	1.5	5	5/32
55013X	55113X	14.8	22.5	3/8-16	23	2	6	3/16
55014X	55114X	14.8	27.0	1/2-13	26	2.5	8	7/32
55015X	55115X	20.2	40.5	5/8-11	33	3.5	10	5/16

Standard End Pressure – Metric

Steel Part No.	Stainless Steel Part No.	End Force (Newtons)		A	D	B	C	E
		Initial	Final					
69201X	69301X	1,5	3	M3x0.5	1,5	9	0,5	1,5
69202X	69302X	4	10	M4x0.7	2,5	10	0,8	2
69203X	69303X	6	11	M5x0.8	3	14	0,9	2,5
69204X	69304X	9	13	M6x1.0	3,5	15	1	3
69205X	69305X	15	30	M8x1.25	5	18	1,5	4
69206X	69306X	20	35	M10x1.5	6	23	2	5
69207X	69307X	30	55	M12x1.75	8	26	2,5	6
69208X	69308X	65	125	M16x2.0	10	33	3,5	8
69209X	69309X	80	160	M20x2.5	12	43	4,5	10
69210X	69310X	90	180	M24x3.0	15	48	5,5	12

Heavy End Pressure – Metric

Steel Part No.	Stainless Steel Part No.	End Force (Newtons)		A	D	B	C	E
		Initial	Final					
69221X	69321X	5	7	M3x0.5	1,5	9	0,5	1,5
69222X	69322X	12	22	M4x0.7	2,5	10	0,8	2
69223X	69323X	19	30	M5x0.8	3	14	0,9	2,5
69224X	69324X	28	40	M6x1.0	3,5	15	1	3
69225X	69325X	47	73	M8x1.25	5	18	1,5	4
69226X	69326X	66	100	M10x1.5	6	23	2	5
69227X	69327X	66	120	M12x1.75	8	26	2,5	6
69228X	69328X	90	180	M16x2.0	10	33	3,5	8
69229X	69329X	115	240	M20x2.5	12	43	4,5	10
69230X	69330X	130	270	M24x3.0	15	48	5,5	12