

Spring Plungers – Pin Style Slotted

- Material:
 - Steel Body: ball in steel, spring steel D
- Surface finish:
 - Steel: black oxide finish
 - Stainless Steel Body: 300 series, ball 400 series, spring 300series

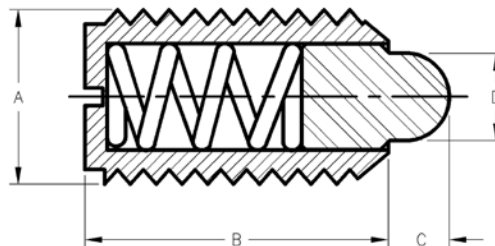

NEW



Available without locking element only

Standard End Pressure – Metric

Steel Part No.	Stainless Steel Part No.	End Force (Newtons)		A	B	C	D
		Initial	Final				
69401X	69501X	6	20	M4	9	1,5	1,8
69402X	69502X	6	20	M5	12	2	2,4
69403X	69503X	7	20	M6	14	2	2,7
69404X	69504X	15	30	M8	16	2	4
69405X	69505X	20	35	M10	19	2,5	4,5
69406X	69506X	30	55	M12	22	3,5	6
69407X	69507X	45	100	M16	24	4,5	8,5
69408X	69508X	60	120	M20	30	6,5	10

Light End Pressure – Metric

Steel Part No.	Stainless Steel Part No.	End Force (Newtons)		A	B	C	D
		Initial	Final				
69420X	69520X	3	10	M4	9	1,5	1,8
69421X	69521X	3	10	M5	12	2	2,4
69422X	69522X	4	10	M6	14	2	2,7
69423X	69523X	7	15	M8	16	2	4
69424X	69524X	9	16	M10	19	2,5	4,5
69425X	69525X	14	26	M12	22	3,5	6
69426X	69526X	22	50	M16	24	4,5	8,5
69427X	69527X	30	60	M20	30	6,5	10

Spring Plungers – Hexagon Socket Steel Body

- Material: Steel Body quality class 5.8, pressure pin in steel or plastic, spring in spring steel D
- Finish: Steel with black oxide finish, pressure pin in steel, hardened



NEW

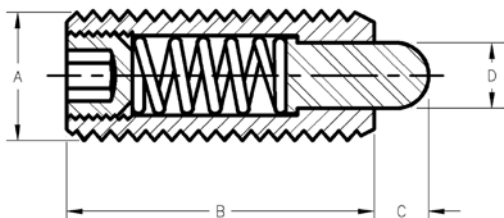

Available without locking element only

Standard End Pressure – Metric

Steel Pin Part No.	Plastic Pin Part No.	End Force (Newtons)		A	B	C	D
		Initial	Final				
69601X	69651X	0,5	3	M3	10	1,5	1
69602X	69652X	5	16	M4	15	1,5	1,5
69603X	69653X	6	20	M5	18	2,3	2,4
63705X	69654X	7	20	M6	20	2,5	2,7
63706X	69655X	9	35	M8	22	3	3,5
63707X	69656X	9	35	M10	22	3	4
63708X	69657X	10	55	M12	28	4	6
69604X	69658X	45	100	M16	32	5	7,5
69605X	-	60	120	M20	40	7	10
69606X	-	80	160	M24	52	10	12

Heavy End Pressure – Metric

Steel Pin Part No.	End Force (Newtons)		A	B	C	D
	Initial	Final				
69620X	11	29	M5	18	2,3	2,4
69621X	14	37	M6	20	2,5	2,7
69622X	22	65	M8	22	3	3,5
69623X	19	70	M10	22	3	4
69624X	25	85	M12	28	4	6
69625X	60	150	M16	32	5	7,5
69626X	75	190	M20	40	7	10
69627X	95	240	M24	52	10	12

Light End Pressure – Metric

Steel Pin Part No.	Plastic Pin Part No.	End Force (Newtons)		A	B	C	D
		Initial	Final				
69610X	69660X	2	7	M4	15	1,5	1,5
69611X	69661X	3	10	M5	18	2,3	2,4
69612X	69662X	3	9	M6	20	2,5	2,7
69613X	69663X	4	16	M8	22	3	3,5
69614X	69664X	4	16	M10	22	3	4
69615X	69665X	5	27	M12	28	4	6
69616X	69666X	20	45	M16	32	5	7,5