

## Spring Plungers – Hexagon Socket Stainless Steel Body

- Material: Body 1.4305, pressure pin 1.4034 or plastic, spring 1.4310
- Finish: Stainless steel body with natural finish, pressure pin in stainless steel, hardened

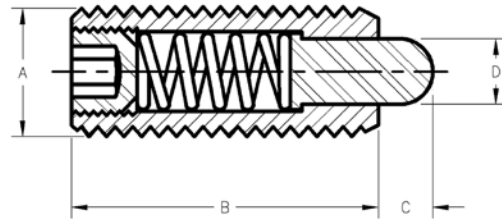

Available without locking element only



### Standard End Pressure – Metric

Stainless Pin Part No.	Plastic Pin Part No.	End Force (Newtons)		A	B	C	D
		Initial	Final				
69701X	69751X	0,5	3	M3	10	1,5	1
69702X	69752X	5	16	M4	15	1,5	1,5
69703X	69753X	5	17	M5	18	2,3	2,4
69704X	69754X	6	17	M6	20	2,5	2,7
69705X	69755X	7	29	M8	22	3	3,5
69706X	69756X	8	31	M10	22	3	4
69707X	69757X	10	47	M12	28	4	6
69608X	69758X	45	100	M16	32	5	7,5

### Heavy End Pressure – Metric

Stainless Pin Part No.	End Force (Newtons)		A	B	C	D
	Initial	Final				
69801X	9	26	M5	18	2,3	2,4
69802X	11	35	M6	20	2,5	2,7
69803X	15	48	M8	22	3	3,5
69804X	15	58	M10	22	3	4
69805X	19	74	M12	28	4	6

## Metric Spring Plungers

- Material:
  - Steel Body: 12L14 Steel, Black Oxide Finish
  - Stainless Steel Body: 303 Stainless Steel
  - Steel Nose: 12L14 Steel, Black Oxide Finish
  - Stainless Steel Nose: 303 Stainless Steel
- Many sizes conform to TCMAI standards
- All dimensions in metric format

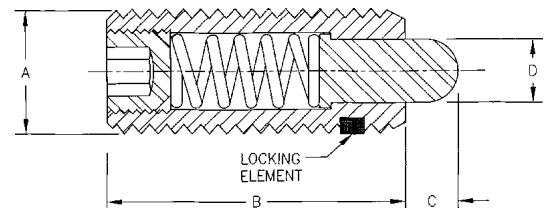

Steel Part No.	Stainless Steel Part No.	End Force (Newtons)		Thread A	B mm (in.)	C mm (in.)	+0.00/-0.025 D mm (in.)
		Initial	Final				
63701	63720	4.00	11.15	M6 x 1.0	20 (.787)	2.5 (.098)	2.7 (.106)
63702	63721	5.60	15.60	M8 x 1.25	22 (.866)	3 (.118)	3.5 (.138)
63703	63722	5.60	15.60	M10 x 1.50	22 (.866)	3 (.118)	4 (.157)
63704	63723	10.00	24.50	M12 x 1.75	28 (1.102)	4 (.157)	6 (.236)
63705	63724	1.60	4.50	M6 x 1.0	20 (.787)	2.5 (.098)	2.7 (.106)
63706	63725	2.00	7.80	M8 x 1.25	22 (.866)	3 (.118)	3.5 (.138)
63707	63726	2.00	7.80	M10 x 1.50	22 (.866)	3 (.118)	4 (.157)
63708	63727	2.25	12.30	M12 x 1.75	28 (1.102)	4 (.157)	6 (.236)

### NYLON THREAD LOCKING ELEMENT IS STANDARD ON ALL SIZES

To order ball plungers without a locking element, simply add an "X" to the end of the part number (ex. 52821X). Pricing is the same with or without locking element.