

## Hex Drive Knob Retractable: Locking

- Zinc gold chromate finish
- Hand-retractable locking plunger
- Withstands side loading
- Chamfered for easy alignment
- Built in hex drive wrench
- Plunger can be completely withdrawn into the body and locked into a retracted position

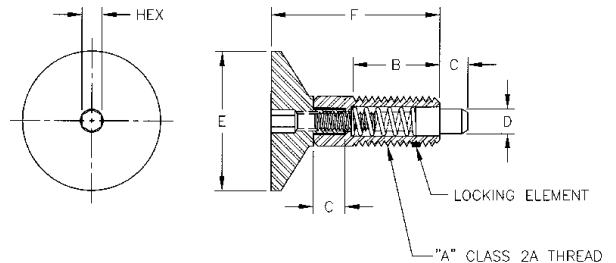

Part No.	End Force (lbs)		Thread A	B	C	D	E	F	Hex
	Initial	Final							
<b>58501</b>	1	4	1/4-20	.400	.125	.123	.750	.805	.125
<b>58502</b>	1	6	5/16-18	.530	.187	.154	.875	1.070	.125
<b>58503</b>	1	8	3/8-16	.750	.220	.185	1.000	1.260	.218
<b>58504</b>	1	10	1/2-13	.650	.250	.248	1.250	1.380	.250



## T-Handle Retractable Plunger: Locking

- Easy to grasp handle
- Locking plunger
- Withstands side loading
- Chamfered for easy alignment
- Plunger can be completely withdrawn into the body and locked into a retracted position

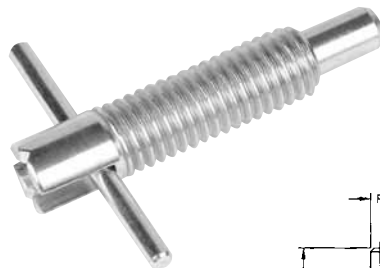

Steel Part No.*	Stainless Steel Part No.	End Force (lbs)		Thread A	B	C	D	E	F	G
		Initial	Final							
<b>57701</b>	<b>57750</b>	1.0	2.5	1/4-20	1.14	.250	.155	1.13	.13	.8
<b>57702</b>	<b>57751</b>	2.0	4.0	3/8-16	1.68	.375	.233	1.50	.13	1.2
<b>57703</b>	<b>57752</b>	2.0	5.0	1/2-13	2.00	.500	.312	2.00	.16	1.4
<b>57704</b>	<b>57753</b>	2.5	5.0	5/8-11	2.38	.625	.375	2.50	.19	1.7

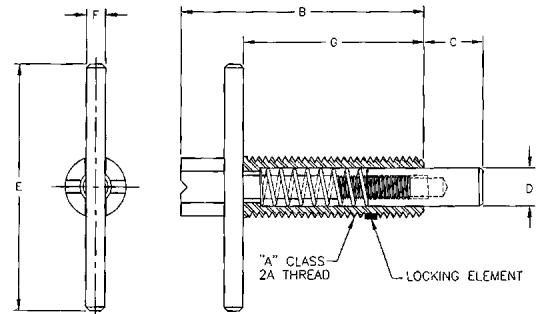

\*Zinc Plated Clear Chromate Finish

**NYLON THREAD LOCKING ELEMENT IS STANDARD ON ALL SIZES SHOWN ON THIS PAGE**  
*To order ball plungers without a locking element, simply add an "X" to the end of the part number (ex. 52821X). Pricing is the same with or without locking element.*