

RELOCK-8 STATION WORKHOLDING SYSTEM

The ReLock 8-Station's compact and lightweight unibody design is perfect for horizontal machining centers. The unibody is manufactured from 80,000 PSI Ductile Cast Iron and the ways are flamed hardened and precision ground to accuracies of $\pm .0005"$. It's also ideal for use with rotary indexers in vertical machining center applications. For special requirements, please use the ReLock-8 Indexer Assembly Quotation Worksheet on page 203.

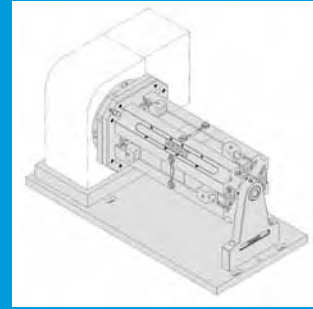

ReLock-8 Support Bracket Part Number RSB4000

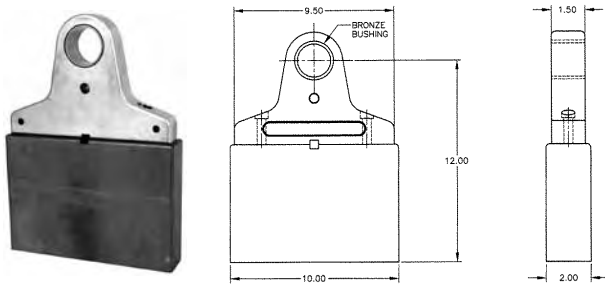

- Optional ReLock support bracket incorporates a bronze bushing and grease fitting for durability.
- Customer must modify base to required height.

ReLock-8 Adapter Plate

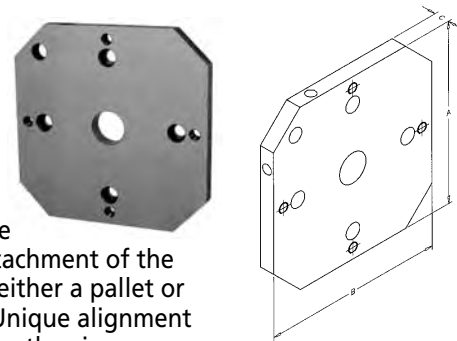

Optional adapter plate simplifies attachment of the ReLock-8 to either a pallet or an indexer. Unique alignment feature allows the vise to be oriented to indexing quickly and accurately.

Vise Size	Part Number	A	B	C
4"	RAP4008	9.000	9.000	.750
6"	RAP6008	12.000	12.000	1.000

ReLock-8 Support/Alignment Nose

Optional support nose works in conjunction with the support bracket and adapter plate for long lasting precision to $.001"$ T.I.R.

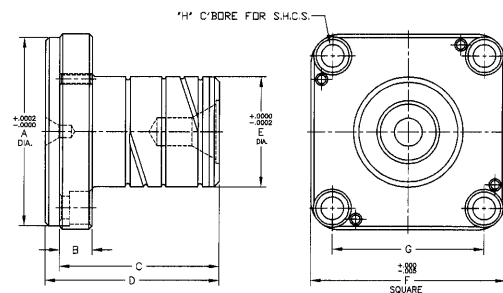

Vise Size	Part Number	A	B	C	D	E	F	G	H
4"	RSN4008	2.750	.469	2.750	3.000	1.9672	2.875	2.207	5/16-18
6"	RSN6008	3.375	.593	2.875	3.125	1.9672	3.500	2.726	3/8-16
8"	RSN8008	5.125	.718	3.000	3.250	1.9672	5.250	4.187	1/2-13

Single Station Conversion Plate for ReLock-8

- Allows each station to be converted from double to single station when used in conjunction with SnapLock carrier jaw.
- Capacities and configuration examples are illustrated on page 171.
- Not compatible with ReLock Compact Quad.
- See pg. 172 for mounting info.



Vise Size	Part Number	A	B	C
4"	RCP4008	5.50	1.350	.720
6"	RCP6008	8.00	2.000	.720
8"	RCP8008	10.25	2.500	.970

