

SPRING LOADED DEVICES

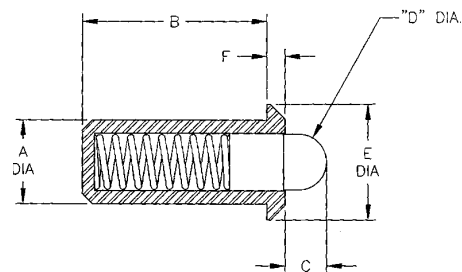

Press Fit Spring Plungers

- Material:
 - Steel Body: 12L14 Steel
 - Stainless Steel Body: 303 Stainless Steel
 - Steel Plunger: 12L14 Steel
 - Stainless Steel Plunger: 303 Stainless Steel
- Ideal for installation in softer materials such as aluminum, wood, or plastic
- Withstands high temperatures
- No thread adjustment
- Longer travel



Steel Part No.	Stainless Steel Part No.	End Force (lbs)*		+.002 -.000 A	B	C	D	E	F
		Initial	Final						
53601	53650	.75	2.00	.188	.441	.094	.121	.250	.044
53602	53651	1.25	3.00	.250	.521	.125	.168	.312	.055
53603	53652	2.50	7.00	.375	.788	.187	.234	.500	.096
53604	53653	4.00	9.00	.500	1.100	.250	.332	.688	.134
53605	53654	1.50	4.50	.188	.441	.094	.121	.250	.044
53606	53655	2.50	6.00	.250	.521	.125	.168	.312	.055
53607	53656	5.00	14.00	.375	.788	.187	.234	.500	.096
53608	53657	5.00	18.00	.500	1.100	.250	.332	.688	.134

Spring and Ball Plunger Wrenches

Designed to eliminate excessive spring compression during installation and removal of spring and ball plungers.

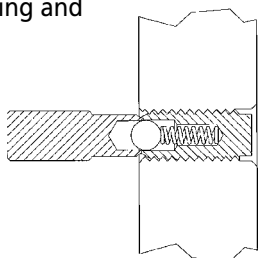

Part No.	Fits Following Spring and Ball Plunger Sizes		Weight (lbs/100pcs)
	Inches	MM	
53001	6-32	–	1
53002	8-32	M4	1
53003	10-32	M5	1
53004	1/4-20	M6	1.5
53005	5/16-18	M8	3
53006	3/8-16	M10	3
53007	1/2-13	M12	5
53008	5/8-11	–	9
53009	3/4-10	–	13
53010	1-8	–	19

Stainless Steel Ball Buttons

The ideal mating detent for ball plungers or other similar applications. Hardened and ground 440C stainless steel.

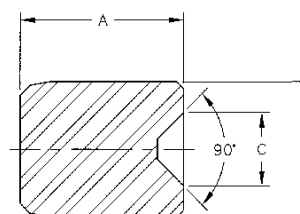

Part No.	For use with Ball Dia.	A	+.0002 -.0000	
			B	C
57501	.0620	1/8	.1075	.056
57502	.0780	1/8	.1175	.051
57503	.0938	3/16	.1614	.069
57504	.1250	1/4	.2034	.111
57505	.1560	5/16	.2559	.139
57506	.1875	3/8	.3284	.164
57507	.2813	1/2	.4378	.241
57508	.3750	5/8	.5472	.330