

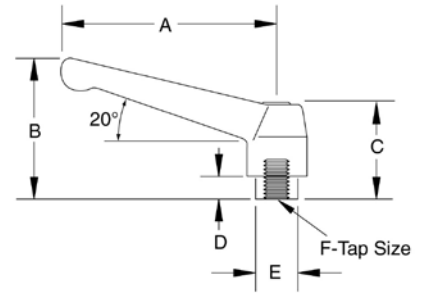

CLAMPING LEVERS & HANDLES

Plastic Classic Tapped Style – Inch Steel and Stainless Steel

High quality Nylon 6 handle reinforced with 30% glass fiber. Molded in zinc metal teeth make these handles extremely durable. RoHS compliant.



- Material:
 - Handle: Nylon 6 reinforced with 30% glass fiber
 - Insert, screw and spring:
 - Steel: Black zinc coated carbon steel
 - Stainless: Grade 303 stainless steel
- Temperature rating: -40F to +265F
- Lift & Rotate: Handle is adjustable throughout a 360 degree rotation

Stainless Part No.	Steel Part No.	A	B	C	D	E	F
70842	70858	1.77	1.38	.96	.16	.39	10-24
70843	70859	1.77	1.38	.96	.16	.39	1/4-20
70845	70861	1.77	1.38	.96	.16	.39	10-32
70846	70862	2.48	1.77	1.22	.26	.53	1/4-20
70847	70863	2.48	1.77	1.22	.26	.53	5/16-18
70850	70866	3.07	2.12	1.42	.31	.63	5/16-18
70851	70867	3.07	2.12	1.42	.31	.63	3/8-16
70854	70870	3.62	2.56	1.69	.43	.75	3/8-16
70855	70871	3.62	2.56	1.69	.43	.75	1/2-13

Special order stud lengths, materials and colors available

Unique design reduces the cavity area around the retention screw for less debris accumulation

Crank Handles – Aluminum with Folding or Revolving Grip

DIN standard die cast aluminum alloy crank handles with high quality black powder coated textured finish. Special bores, keyways and set screws available.

- Material: Die cast aluminum with black powder coating
- Handle: Phenolic permanently lubricated
- Round or square bore available

Permanently lubricated safety folding handle.

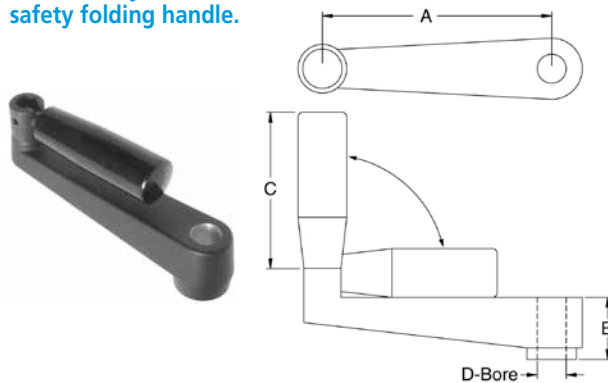

Permanently lubricated revolving handle with threaded spindle and bottom hex socket for easy removal or replacement.

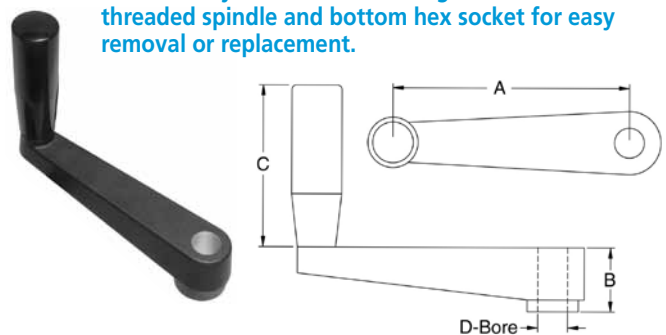

With Folding Grip

Part No.	A	B	C	Bore D
70900	3.94	1.10	2.56	3/8"
70901	3.94	1.10	2.56	3/8" square
70902	3.94	1.10	2.56	1/2"
70903	3.94	1.10	2.56	1/2" square
70904	4.92	1.34	3.92	1/2"
70905	4.92	1.34	3.92	1/2" square
70906	4.92	1.34	3.92	5/8"
70907	4.92	1.34	3.92	5/8" square

With Revolving Grip

Part No.	A	B	C	Bore D
70908	3.15	.94	1.97	5/16"
70909	3.15	.94	1.97	5/16" square
70910	3.15	.94	1.97	3/8"
70911	3.15	.94	1.97	3/8" square
70912	3.94	1.10	2.56	3/8"
70913	3.94	1.10	2.56	3/8" square
70914	3.94	1.10	2.56	1/2"
70915	3.94	1.10	2.56	1/2" square
70916	4.92	1.34	3.15	1/2"
70917	4.92	1.34	3.15	1/2" square
70918	4.92	1.34	3.15	5/8"
70919	4.92	1.34	3.15	5/8" square