

TOOLING COMPONENTS

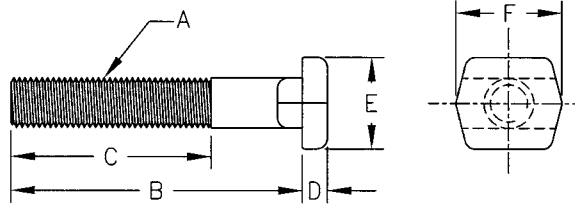

Tugger® T-Slot Bolts

- Black Oxide Finish
- Medium Carbon Steel
- T-Slot Bolt head is undersized to fit machine table slot
- Thread Class 2A UNC
- Special lengths and sizes quoted upon request



Part No.	Thread A	B	C	D	E	F	Table Slot	Weight (lbs/100pcs)
45203	3/8-16	1-1/2	1	3/16	11/16	13/16	3/8	7
45205	3/8-16	2	1-1/2	3/16	11/16	13/16	3/8	8
45207	3/8-16	2-1/2	2	3/16	11/16	13/16	3/8	10
45209	3/8-16	3	2	3/16	11/16	13/16	3/8	11
45210	3/8-16	3-1/2	2	3/16	11/16	13/16	3/8	12.5
45211	3/8-16	4	2	3/16	11/16	13/16	3/8	14
45212	3/8-16	4-1/2	2	3/16	11/16	13/16	3/8	15
45213	3/8-16	5	2	3/16	11/16	13/16	3/8	17.5
45214	3/8-16	5-1/2	2	3/16	11/16	13/16	3/8	19
45215	3/8-16	6	2	3/16	11/16	13/16	3/8	20
45216	3/8-16	7	2	3/16	11/16	13/16	3/8	23
45217	3/8-16	8	2	3/16	11/16	13/16	3/8	26
45402	1/2-13	1-1/2	1	1/4	7/8	1-3/16	1/2	14
45404	1/2-13	2	1-1/2	1/4	7/8	1-3/16	1/2	17
45406	1/2-13	2-1/2	2	1/4	7/8	1-3/16	1/2	19
45408	1/2-13	3	2	1/4	7/8	1-3/16	1/2	22
45409	1/2-13	3-1/2	2	1/4	7/8	1-3/16	1/2	23.5
45410	1/2-13	4	2	1/4	7/8	1-3/16	1/2	26.5
45411	1/2-13	4-1/2	2	1/4	7/8	1-3/16	1/2	29
45412	1/2-13	5	2	1/4	7/8	1-3/16	1/2	32
45413	1/2-13	5-1/2	2	1/4	7/8	1-3/16	1/2	35
45414	1/2-13	6	2	1/4	7/8	1-3/16	1/2	39
45415	1/2-13	7	2	1/4	7/8	1-3/16	1/2	70
45416	1/2-13	8	2	1/4	7/8	1-3/16	1/2	48
45417	1/2-13	9	2	1/4	7/8	1-3/16	1/2	54
45418	1/2-13	10	2	1/4	7/8	1-3/16	1/2	59
45419	1/2-13	12	2	1/4	7/8	1-3/16	1/2	71
45501	5/8-11	1-1/2	1	11/32	1-1/8	1-5/16	5/8	25
45502	5/8-11	2	1-1/2	11/32	1-1/8	1-5/16	5/8	29
45504	5/8-11	2-1/2	2	11/32	1-1/8	1-5/16	5/8	33
45506	5/8-11	3	2	11/32	1-1/8	1-5/16	5/8	37
45507	5/8-11	3-1/2	2	11/32	1-1/8	1-5/16	5/8	42
45508	5/8-11	4	2	11/32	1-1/8	1-5/16	5/8	45
45509	5/8-11	4-1/2	2	11/32	1-1/8	1-5/16	5/8	49
45510	5/8-11	5	2	11/32	1-1/8	1-5/16	5/8	53
45511	5/8-11	5-1/2	2	11/32	1-1/8	1-5/16	5/8	57
45512	5/8-11	6	2	11/32	1-1/8	1-5/16	5/8	61
45513	5/8-11	7	2	11/32	1-1/8	1-5/16	5/8	69
45514	5/8-11	8	2	11/32	1-1/8	1-5/16	5/8	75
45515	5/8-11	9	2	11/32	1-1/8	1-5/16	5/8	88
45516	5/8-11	10	2	11/32	1-1/8	1-5/16	5/8	96
45517	5/8-11	12	2	11/32	1-1/8	1-5/16	5/8	114

Part No.	Thread A	B	C	D	E	F	Table Slot	Weight (lbs/100pcs)
45601	3/4-10	2	1-1/2	15/32	1-1/4	1-9/16	3/4	46
45602	3/4-10	2-1/2	2	15/32	1-1/4	1-9/16	3/4	52
45603	3/4-10	3	2	15/32	1-1/4	1-9/16	3/4	58
45604	3/4-10	3-1/2	2	15/32	1-1/4	1-9/16	3/4	64
45605	3/4-10	4	2	15/32	1-1/4	1-9/16	3/4	69
45606	3/4-10	4-1/2	2	15/32	1-1/4	1-9/16	3/4	74
45607	3/4-10	5	2	15/32	1-1/4	1-9/16	3/4	81
45608	3/4-10	5-1/2	2	15/32	1-1/4	1-9/16	3/4	86
45609	3/4-10	6	2	15/32	1-1/4	1-9/16	3/4	93
45610	3/4-10	7	2	15/32	1-1/4	1-9/16	3/4	105
45611	3/4-10	8	2	15/32	1-1/4	1-9/16	3/4	117
45612	3/4-10	9	2	15/32	1-1/4	1-9/16	3/4	129
45613	3/4-10	10	2	15/32	1-1/4	1-9/16	3/4	143
45614	3/4-10	12	2	15/32	1-1/4	1-9/16	3/4	166
45701	7/8-9	3	2	9/16	1-1/2	1-3/4	7/8	84
45702	7/8-9	4	2	9/16	1-1/2	1-3/4	7/8	99
45703	7/8-9	5	2	9/16	1-1/2	1-3/4	7/8	115
45704	7/8-9	6	2	9/16	1-1/2	1-3/4	7/8	132
45705	7/8-9	7	2	9/16	1-1/2	1-3/4	7/8	149
45706	7/8-9	8	2	9/16	1-1/2	1-3/4	7/8	166
45707	7/8-9	9	2	9/16	1-1/2	1-3/4	7/8	184
45708	7/8-9	10	2	9/16	1-1/2	1-3/4	7/8	199
45709	7/8-9	12	2	9/16	1-1/2	1-3/4	7/8	232
45710	7/8-9	14	2	9/16	1-1/2	1-3/4	7/8	265
45711	7/8-9	16	2	9/16	1-1/2	1-3/4	7/8	300
45712	7/8-9	18	2	9/16	1-1/2	1-3/4	7/8	332
45801	1-8	3	2	11/16	1-3/4	2-1/16	1	123
45802	1-8	4	2	11/16	1-3/4	2-1/16	1	144
45803	1-8	5	2	11/16	1-3/4	2-1/16	1	165
45804	1-8	6	2	11/16	1-3/4	2-1/16	1	188
45805	1-8	7	2	11/16	1-3/4	2-1/16	1	210
45806	1-8	8	2	11/16	1-3/4	2-1/16	1	231
45807	1-8	9	2	11/16	1-3/4	2-1/16	1	252
45808	1-8	10	2	11/16	1-3/4	2-1/16	1	274
45809	1-8	12	2	11/16	1-3/4	2-1/16	1	319
45810	1-8	14	2	11/16	1-3/4	2-1/16	1	360
45811	1-8	16	2	11/16	1-3/4	2-1/16	1	404
45812	1-8	18	2	11/16	1-3/4	2-1/16	1	453