

Plain Clamps

- Tapered nose allows clamping in small areas
- Case Hardened
- Black Oxide Finish
- Material: 1018 Steel

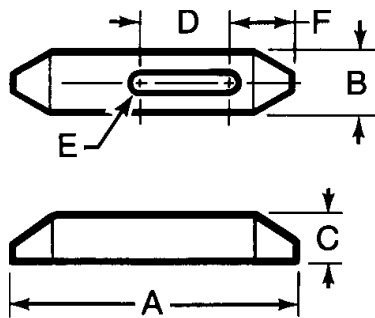

English

Part No.	A	B	C	D	Stud Size E	F	Wt. (lbs/100pcs)
30401	2-1/2	1	1/2	13/16	5/16 and 3/8	27/32	24
30402	4	1	5/8	1-7/16	5/16 and 3/8	1-1/32	48
30403	6	1-1/8	3/4	2-3/16	5/16 and 3/8	1-5/32	105
30404	2-1/2	1-1/8	1/2	11/16	1/2	29/32	24
30405	4	1-1/4	3/4	1-5/16	1/2	1-5/32	67
30406	6	1-1/4	7/8	2-1/16	1/2	1-9/32	37
30407	2-1/2	1-1/4	5/8	9/16	5/8	31/32	31
30408	4	1-1/2	3/4	1-3/16	5/8	1-9/32	83
30409	6	1-1/2	7/8	1-15/16	5/8	1-13/32	150
30410	4	1-1/2	3/4	1-1/16	3/4	1-11/32	75
30411	6	1-1/2	1	1-15/16	3/4	1-15/32	164
30412	8	1-3/4	1-1/8	2-3/16	3/4	1-29/32	321
30413	6	2	1-1/4	1-11/16	7/8 and 1	1-27/32	274
30414	8	2	1-3/8	1-15/16	7/8 and 1	2-1/32	425
30415	10	2	1-1/2	2-15/16	7/8 and 1	2-1/32	618

Metric Dimensions in millimeters

Part No.	A	B	C	D	Stud Size E	F	Wt. (lbs/100pcs)
30401M	64	25	13	21	M6-M8-M10	21	24
30402M	102	25	16	37	M6-M8-M10	26	48
30403M	152	29	19	56	M6-M8-M10	29	105
30404M	64	29	13	18	M12	23	24
30405M	102	32	16	33	M12	29	67
30406M	152	32	19	52	M12	29	37
30407M	64	32	16	14	M16	25	31
30408M	102	38	19	30	M16	31	83
30409M	152	38	22	49	M16	34	150
30410M	102	38	19	27	M20	33	75
30411M	152	38	25	49	M20	37	164
30412M	203	45	29	56	M20	48	321
30413M	152	51	32	43	M24	44	274
30414M	203	51	35	49	M24	52	425
30415M	254	51	38	75	M24	52	618

Tapped End Clamps

- Material: 1018 Steel
- Case Hardened
- Black Oxide Finish

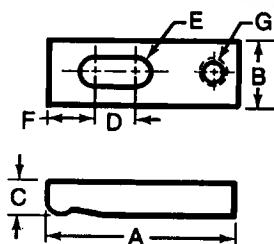

Part No.	A	B	C	D	Stud Size E	F	G	Wt. (lbs/100pcs)
30902	2	5/8	3/8	1/2	1/4	7/16	1/4-20	10
30903	2-1/2	5/8	3/8	1/2	1/4	9/16	1/4-20	14
30905	2-3/4	1	1/2	7/16	5/16	13/16	5/16-18	33
30906	3-1/4	1	1/2	13/16	5/16	7/8	5/16-18	39
30907	4	1	1/2	7/8	5/16	15/16	5/16-18	48
30908	3	1-1/4	5/8	3/4	3/8	9/16	3/8-16	55
30909	4	1-1/4	5/8	1	3/8	3/4	3/8-16	76
30910	5	1-1/4	5/8	1-1/2	3/8	3/4	3/8-16	94
30912	4	1-1/4	5/8	1	1/2	3/4	1/2-13	70
30913	4-1/2	1-1/4	5/8	1-1/2	1/2	13/16	1/2-13	76
30914	5	1-1/4	5/8	1-1/2	1/2	1-1/4	1/2-13	85
30916	6	1-1/4	5/8	1-1/2	1/2	2-1/4	1/2-13	114
30917	4-1/2	1-1/2	3/4	1	5/8	7/8	5/8-11	111
30918	5	1-1/2	3/4	1-1/2	5/8	15/16	5/8-11	120
30919	5-1/2	1-1/2	3/4	1-1/2	5/8	1-7/16	5/8-11	142
30920	6	1-1/2	3/4	1-1/2	5/8	2	5/8-11	152
30921	6	1-3/4	1	1-3/4	3/4	1-1/4	3/4-10	--
30922	7	1-3/4	1	2-1/4	3/4	1-1/4	3/4-10	--
30923	8	1-3/4	1	2-1/4	3/4	1-3/4	3/4-10	--